



URBAN  
— LANDSCAPES —



# CONTENTS

01

ABOUT US

02

OUR TEAM

03

OUR SERVICES

23

RESIDENTIAL

42

COMMERCIAL

42

GALLERY





# URBAN LANDSCAPES

At Urban Landscapes, we pride ourselves on delivering premium landscape solutions to clients across Dubai and the UAE.

Passion for the design and build of inspiring outdoor spaces, and commitment towards delivering extraordinary experiences to our customers are at the heart of who we are, and what we do.

Our extensive portfolio demonstrates our ability to work with a variety of projects, whilst creating beautiful yet functional outdoor living spaces. We deliver on all scales of projects, from intimate family homes to commercial towers and resorts.



# MEET OUR TEAM



**David Harper**  
General Manager



**Sunil Deokar**  
Contracts Manager



**Mediha Zafar**  
HR Manager



**Sunil Nair**  
Operations Manager



**Kenneth Seraspi**  
Design Manager



**Mohammad Tahir**  
Maintenance Manager



**Nuthan Shetty**  
Accounts Manager



**Pran Raj**  
Estimation Manager



**Ramanathan M.**  
QS Manager



**Daryl Justine**  
Senior Landscape Architect



# OUR SERVICES

## LANDSCAPE ARCHITECTURE AND GARDEN DESIGN



- Streetscape design
- Community development landscape
- Private homes and Villas
- Commercial spaces
- Ai integrated design

## IRRIGATION STRATEGY AND DEVELOPMENT



- Irrigation strategy and network design
- Supply and installation of irrigation lines

## PRODUCT AGENCY AND DISTRIBUTION



- Virobuild - Sustainable thatch roofing
- Anjon manufacturing
- Club cars - Trading & Leasing
- Landscape construction equipment - Trading & Leasing
- Street furniture & accessories

## LANDSCAPE CONSTRUCTION AND INSTALLATION



- Hardscape construction and installation
- Softscape procurement and installation

## POOL AND LAKE SYSTEM SPECIALISTS



- Pool design and construction
- Water feature design and construction
- Lake and river design and construction
- Koi pond design and construction

## LANDSCAPE MAINTENANCE



- Maintenance services available for community landscapes
- Private gardens
- Public spaces
- Commercial spaces



# RESIDENTIAL

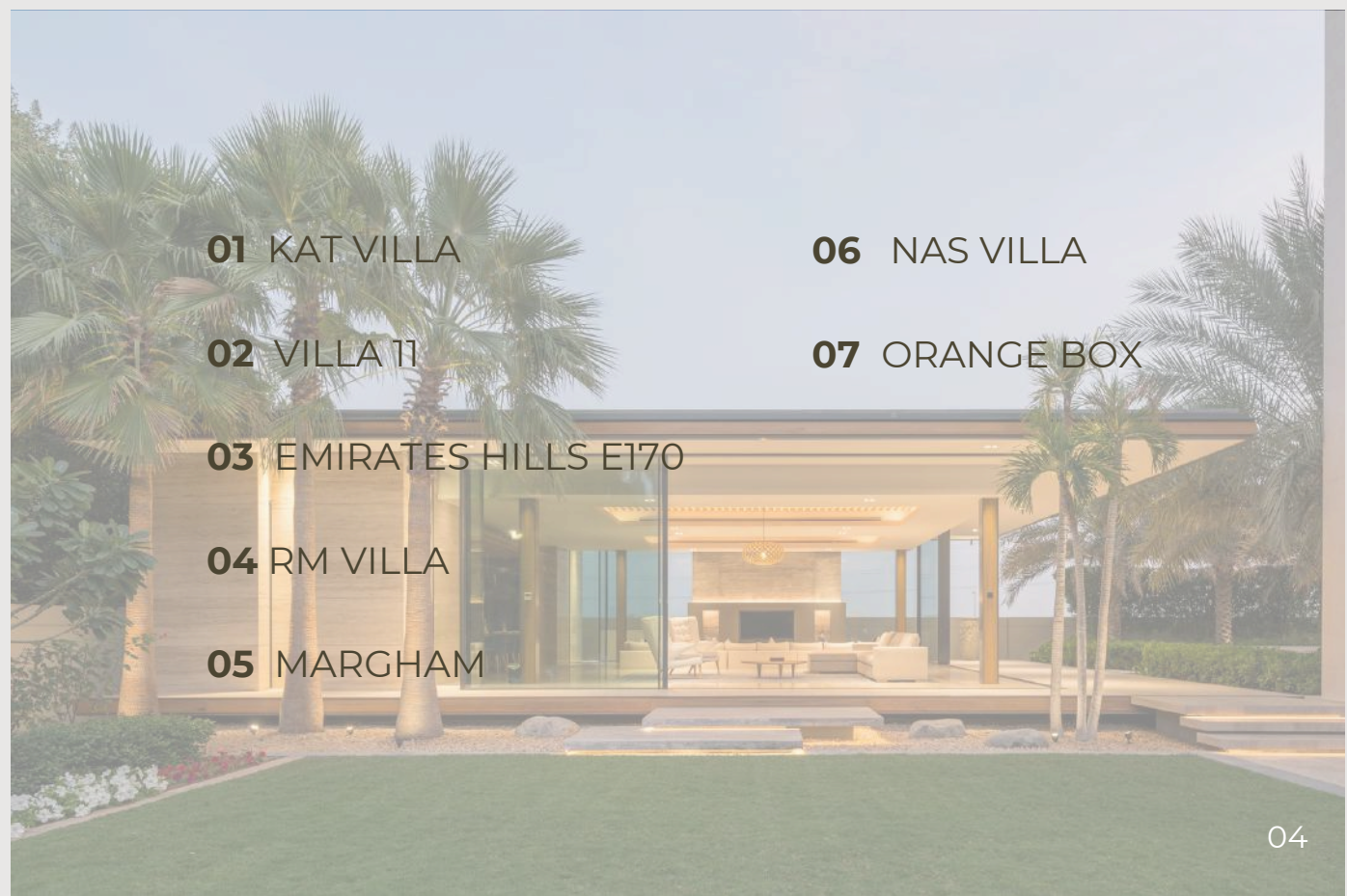

**01** KAT VILLA

**02** VILLA 11

**03** EMIRATES HILLS E170

**04** RM VILLA

**05** MARGHAM

**06** NAS VILLA

**07** ORANGE BOX





PROJECT: KAT VILLA  
LOCATION: NAD AL SHEBA 2  
SCOPE: PROJECT CONSTRUCTION















PROJECT: VILLA 11  
LOCATION: DUBAI HILLS  
SCOPE: DESIGN & CONSTRUCTION

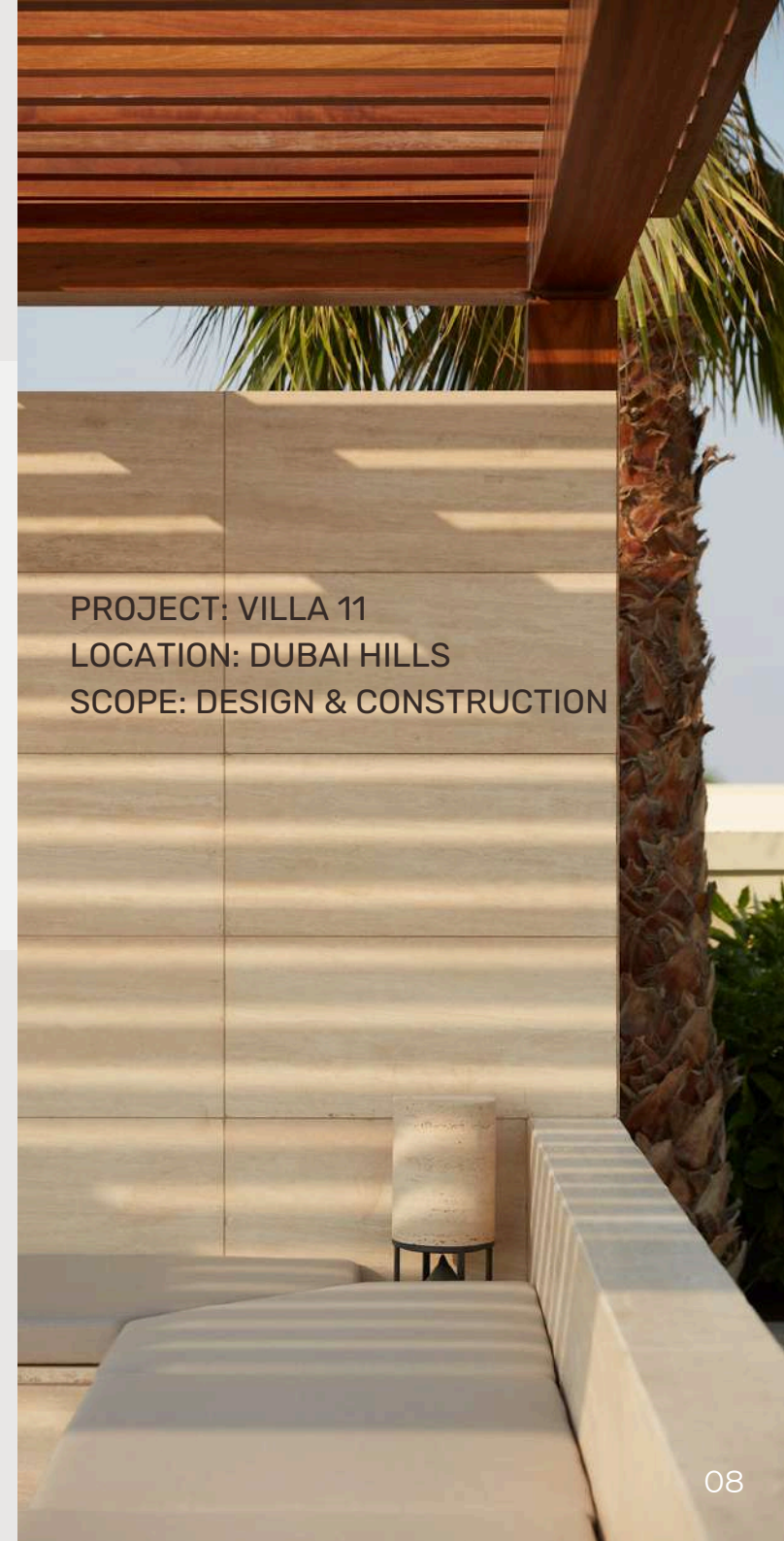







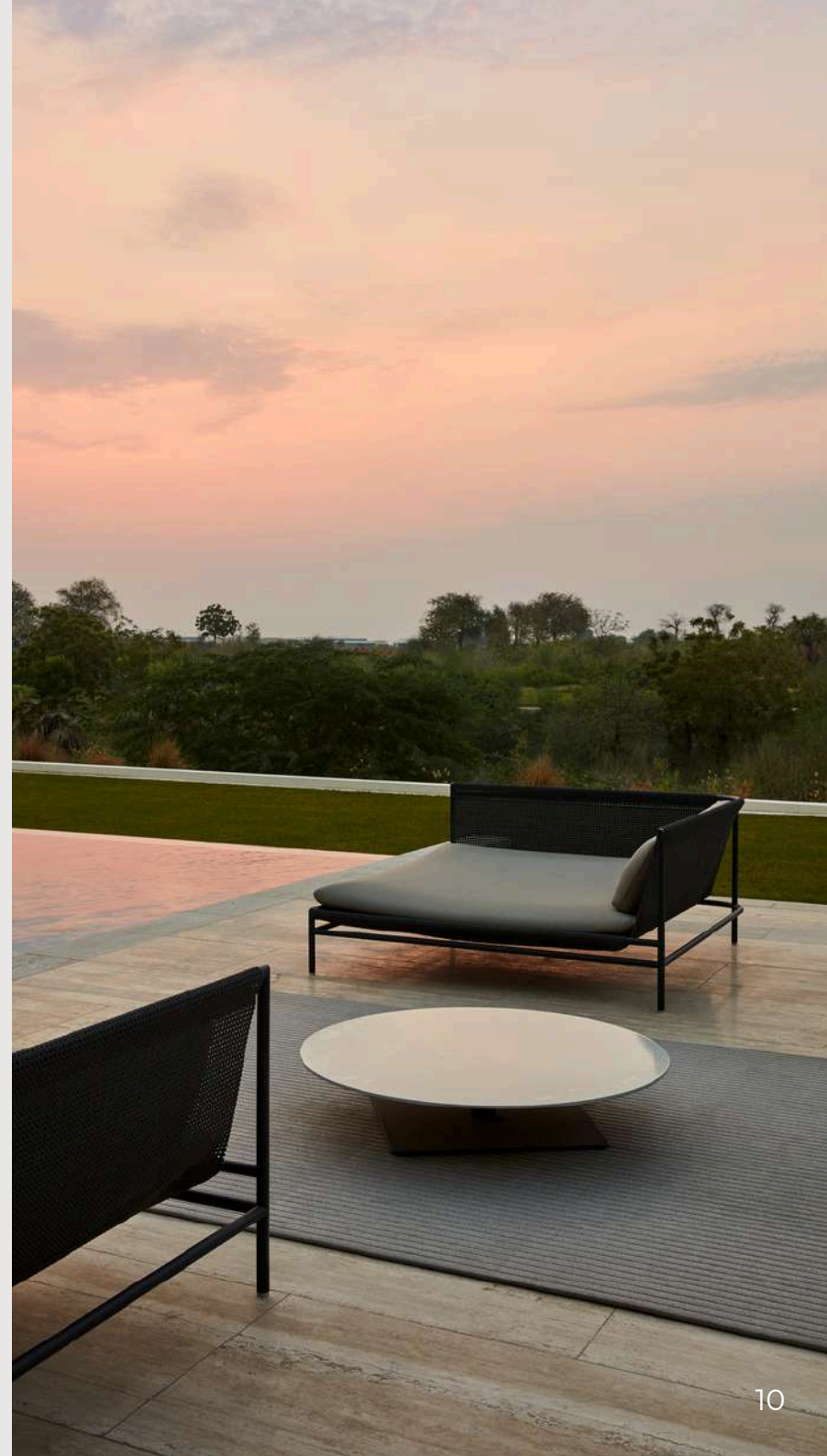



# 03

PROJECT: E170 EMIRATES HILLS  
LOCATION: EMIRATES HILLS,  
DUBAI  
SCOPE: PROJECT CONSTRUCTION











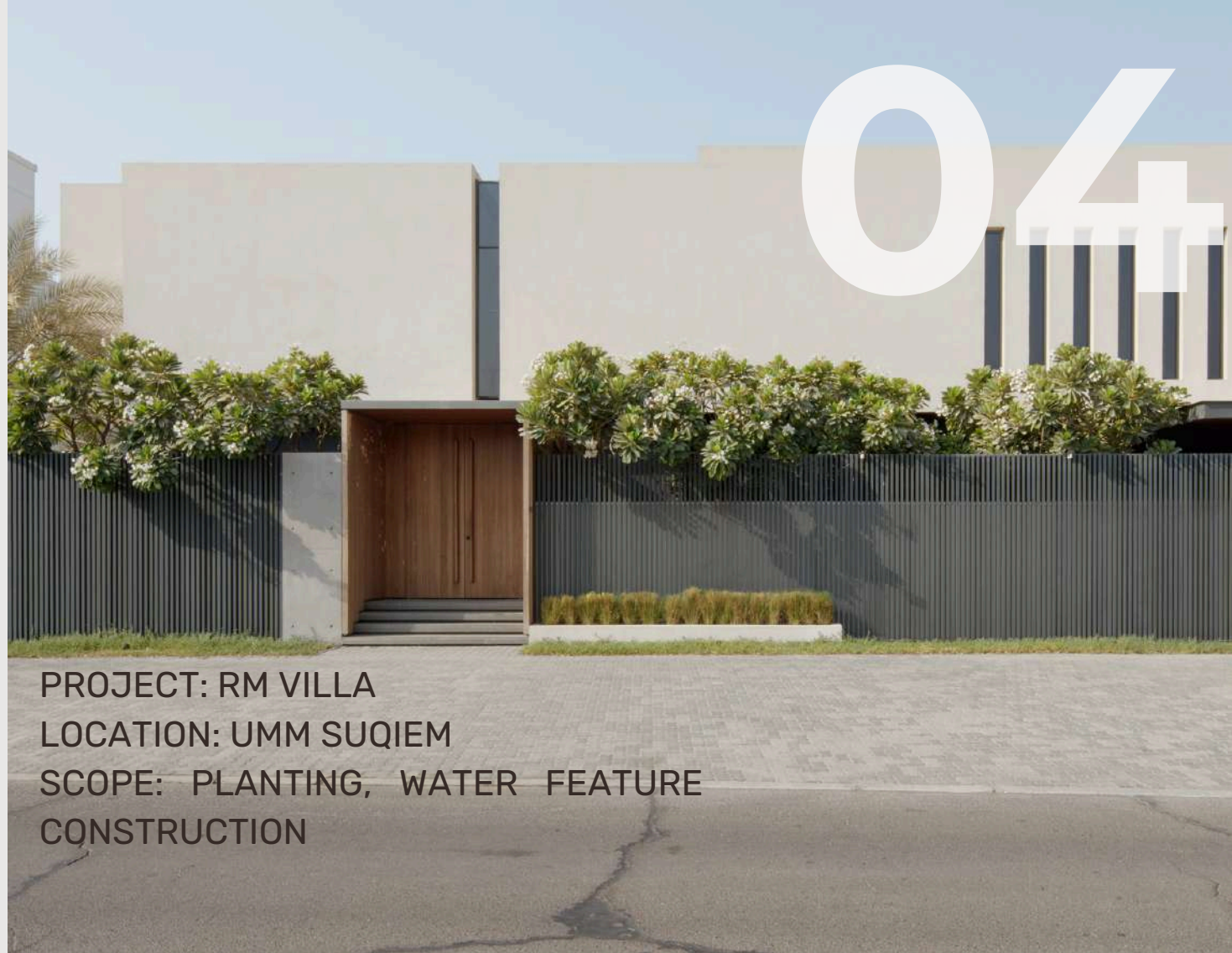

PROJECT: RM VILLA  
LOCATION: UMM SUQIEM  
SCOPE: PLANTING, WATER FEATURE  
CONSTRUCTION









# 05

PROJECT: MARGHAM ESTATE  
LOCATION: MARGHAM, SHARJAH  
SCOPE: DESIGN AND CONSTRUCTION











A photograph of a luxurious villa with a large pond and landscaped garden. The villa is a two-story building with a light-colored facade, arched windows, and a balcony. It is surrounded by a well-manicured lawn, a large pond with a small island in the center, and various tropical plants and trees. The sky is clear and blue.

PROJECT: NAS VILLA  
LOCATION: NAD AL SHEBA 2  
SCOPE: DESIGN AND CONSTRUCTION

06



















# COMMERCIAL

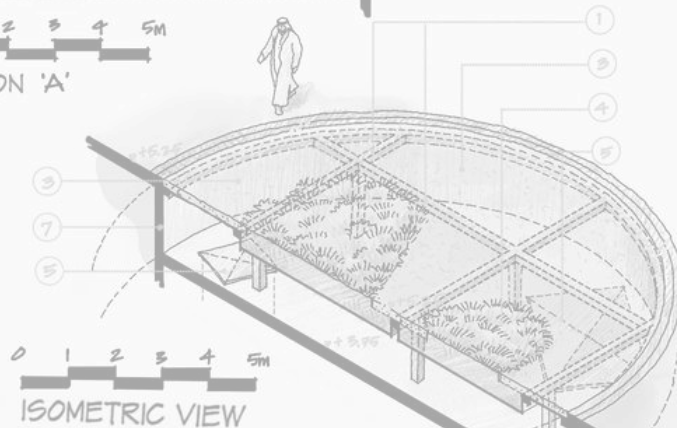
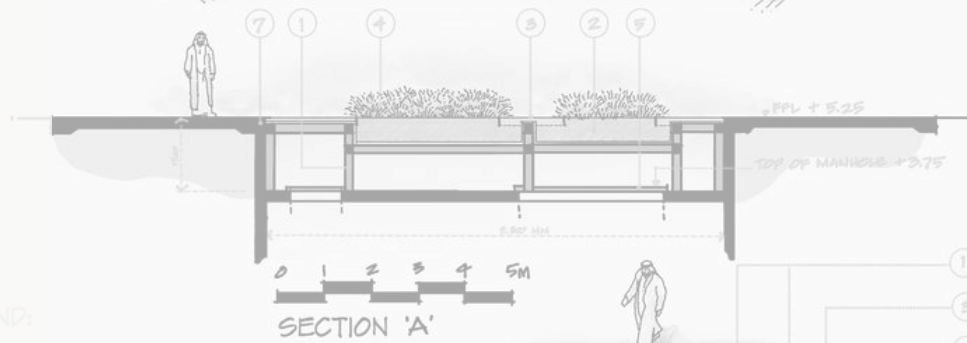
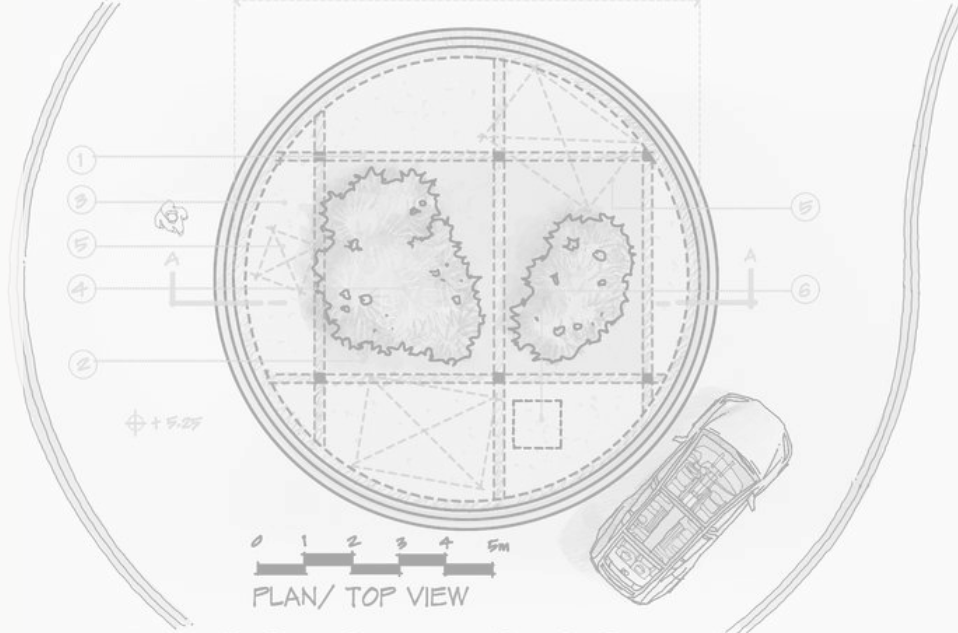

- LEGEND:
- 1. Steel frame structure
  - 2. Planting medium
  - 3. Gravel bed (150mm deep)
  - 4. Low planting
  - 5. Lower level manholes
  - 6. Hatch access at ground level
  - 7. Reinforced concrete wall

**01** MERCEDES BENZ BRAND CENTER

**02** EDEN HOUSE

**03** ONE PALM

**04** BAB AL SHAMS RESORT

**05** GARDEN VIEW VILLAS

**06** NAKHEEL MALL

**07** GRAND MOSQUE AUH

**08** PALM WEST BEACH



# 01



PROJECT: MERCEDES BENZ BRAND CENTER  
LOCATION: DUBAI DESIGN DISTRICT  
SCOPE: PROJECT DESIGN & CONSTRUCTION



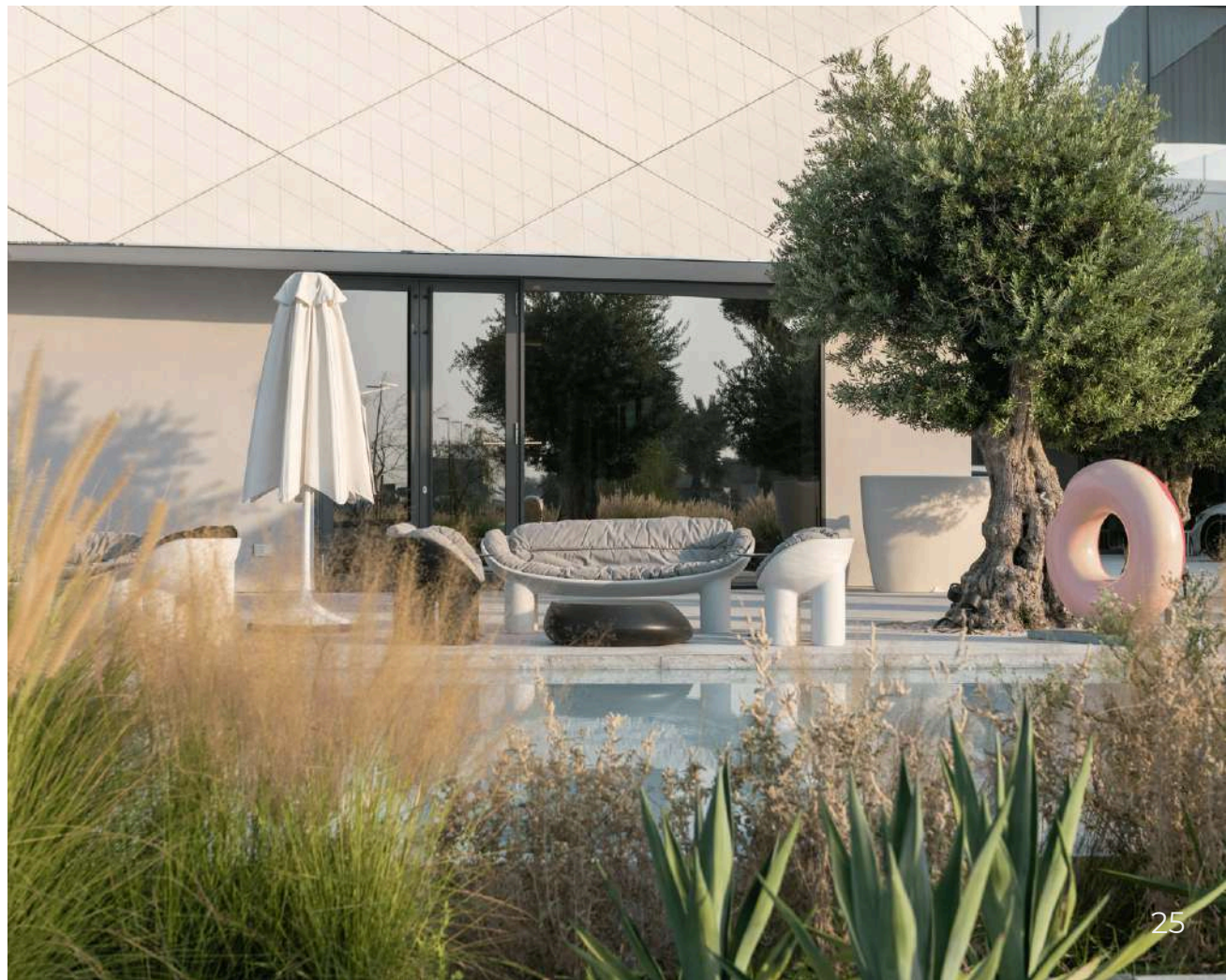



# 02

PROJECT: EDEN HOUSE  
LOCATION: SATWA, DUBAI  
SCOPE: PROJECT CONSTRUCTION











# 03

PROJECT: ONE PALM  
LOCATION: PALM JUMEIRAH  
SCOPE: PLANTING LAYOUT,  
INSTALLATION AND  
MAINTENANCE



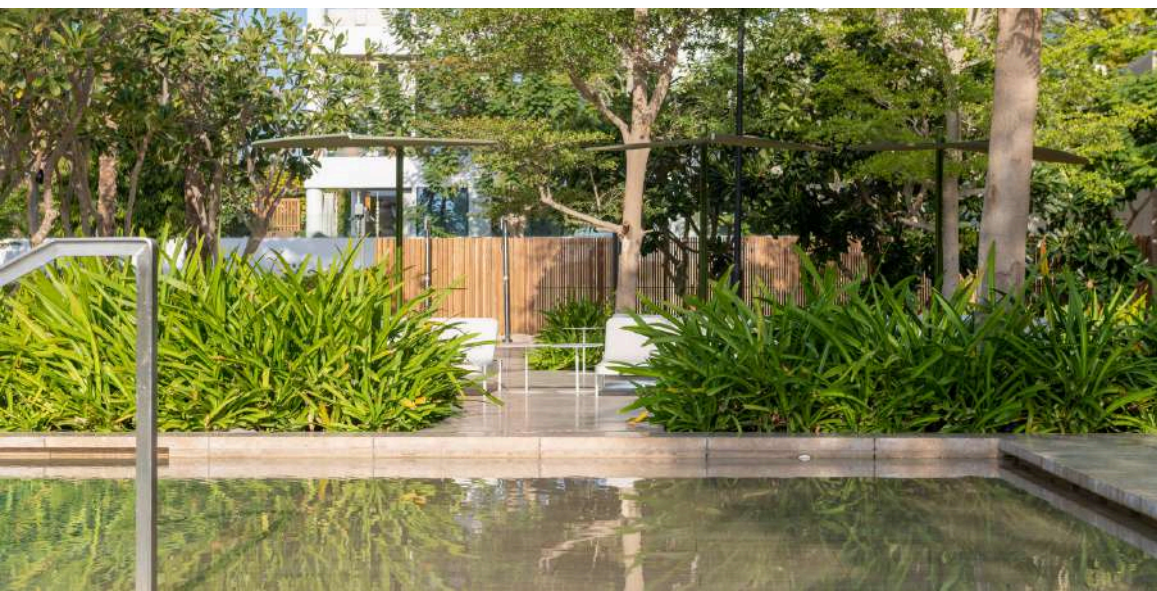









04

PROJECT: BAB AL SHAMS HOTEL  
LOCATION: AL QUDRA  
SCOPE: PLANTING LAYOUT, INSTALLATION,  
MAINTENANCE AND WATER FEATURE DESIGN  
AND CONSTRUCTION







PROJECT: THE GARDENS  
LOCATION: JEBEL ALI, DUBAI  
SCOPE: DESIGN, BUILD AND MAINTENANCE

05









# 06

PROJECT: NAKHEEL MALL ROOFTOP  
LOCATION: PALM JUMEIRAH  
SCOPE: DESIGN, PLANTING LAYOUT AND  
INSTALLATION,  
MAINTENANCE







PROJECT: LECTURE HALL + GRAND MOSQUE  
LOCATION: ABU DHABI  
SCOPE: PROJECT DESIGN & CONSTRUCTION

07



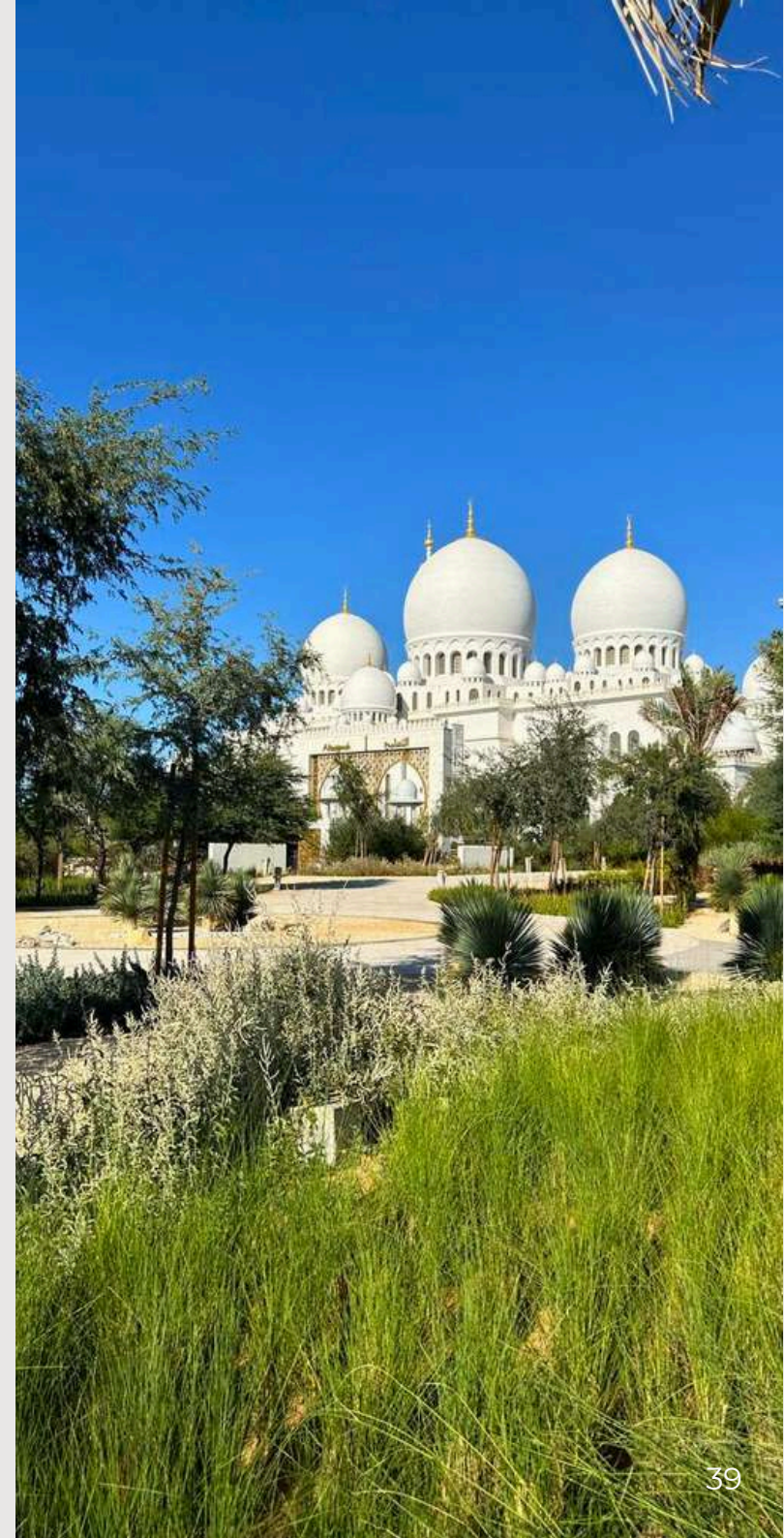



# 08

PROJECT: PALM WEST BEACH  
LOCATION: PALM WEST BEACH  
SCOPE: DESIGN, MAINTENANCE



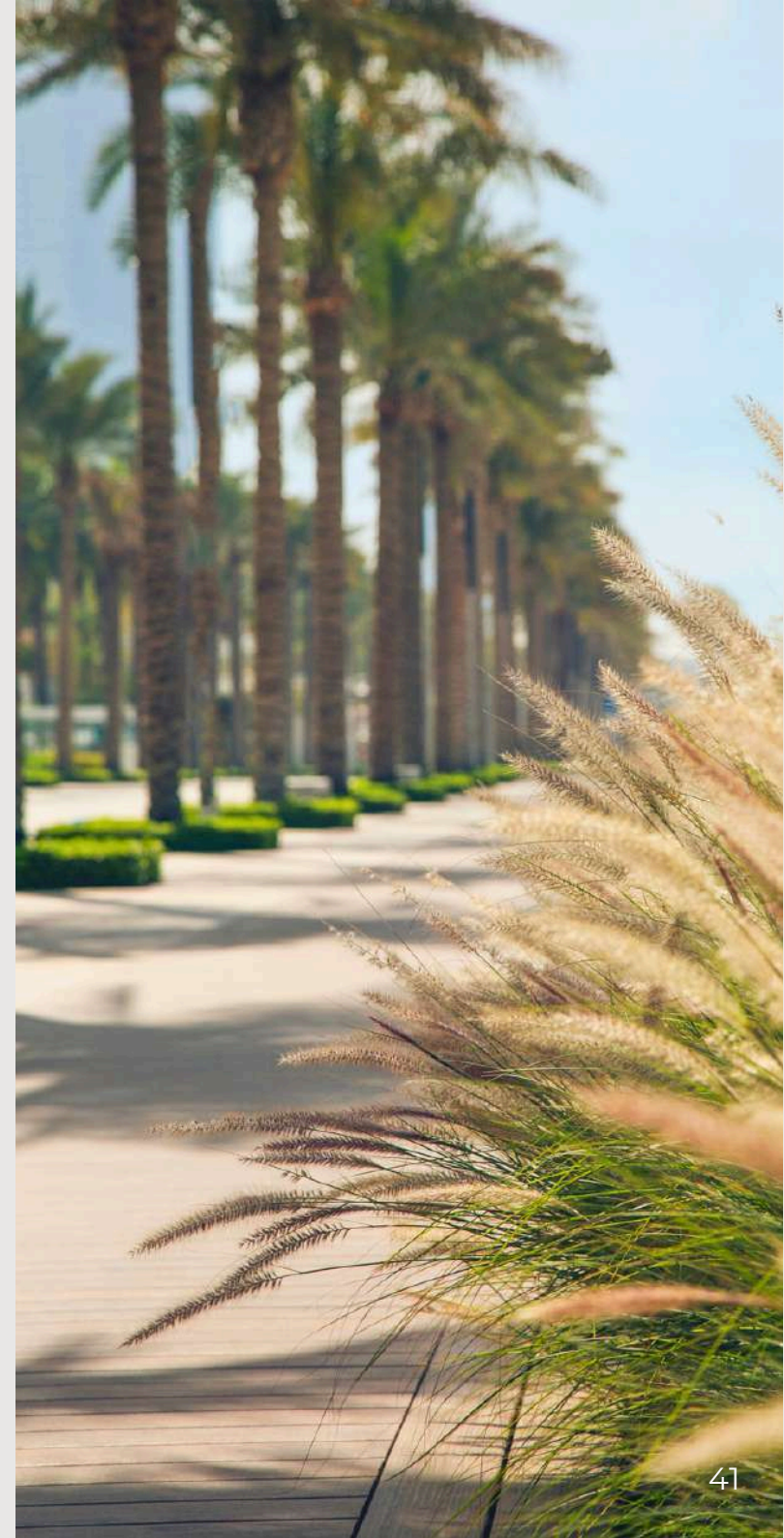



# GALLERY

